



Timber Country

REAL ESTATE

5762 Ted Trout Dr.
Lufkin, Texas 75904
936.875.2905

Highway 69 North, Cheeseland Road

County: Angelina
MLS 53618

\$206,000

Price Per Acre: \$3,404
Status: Active

60.52 Acres—Tract 2



Property Info

STATE:	Texas	COUNTY:	Angelina	STATUS:	Active
CITY:	Central/Wells	ZIP CODE:	75904	STREET:	Cheeseland Road

Property Description

PROPERTY DESCRIPTION: Located in close proximity to Lufkin, this 60.52 acre tract has everything you are looking for in a weekend retreat or to build your dream home. The tract is a combination of pasture and mature pine/hardwood.

DIRECTIONS TO PROPERTY: From Lufkin, take Hwy 69 N to Hwy 7. Go West on Hwy 7 approx. 2.8 miles to Cheeseland Rd. on right. Turn right on Cheeseland Rd., property 2 miles on left.

CORNERS/PROPERTY LINES:

SCHOOL DISTRICT: Central

TREES: Mature pine and mature hardwood

TERRAIN: Level to sloping

RESTRICTIONS: None known

ROAD FRONTAGE: Cheeseland Road

ROAD SURFACE: Oil top

FENCING: Partially (barbed wire)

EASEMENT DESCRIPTION: None known

LAND USE: Recreation and timber investment

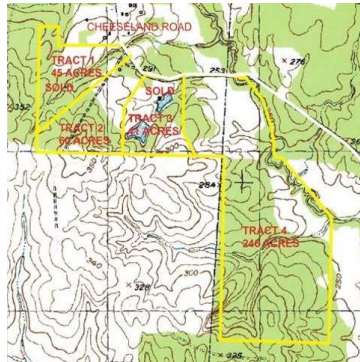

Improvements and Utilities

HOUSE ON PROPERTY: No

UTILITIES: Electricity and phone

WATER/SEWER DESCRIPTION: Community water (Pollok Water)

ADDITIONAL REMARKS: None

Financial

EARNEST MONEY REQUIRED: \$1,000.00

EXEMPTIONS: Agriculture/Timber

MAINTAINANCE FEE: N/A

Listing Agent Information

LISTING BROKER: Michael Sessions
OFFICE: 936-876-2905
MOBILE: 936-676-5284
EMAIL: [Click here](#)



LISTING AGENT: Michael Sessions
OFFICE: 936-876-2905
MOBILE: 936-676-5284
EMAIL: [Click here](#)



Disclaimers

MINERAL RIGHTS: Reserved by previous owners

MINERAL RIGHTS DISCLAIMER: Oil and gas minerals have been reserved by prior owners. Designated drill site plan for the purpose of providing surface waiver for development. Other reservations subject to title and/or seller's contract when applicable.

LEGAL DISCLAIMER: Size is approximate and subject to recorded legal description or surveyed gross acres to include, but not limited to, any acres lying within roades and easement.

LISTING DISCLAIMER: The information on the map(s) is provided "AS IS". There is no warranty regarding the accuracy, adequacy or completeness of the information provided herein and Timber Country Real Estate expressly disclaims liability for errors or omissions. The use and/or reproduction of any marketing materials Timber Country Real Estate and/or its associated clients, including, but not limited to, maps, videos, photos, spreadsheets, diagrams, contracts, documents, etc., is strictly prohibited without written consent.